

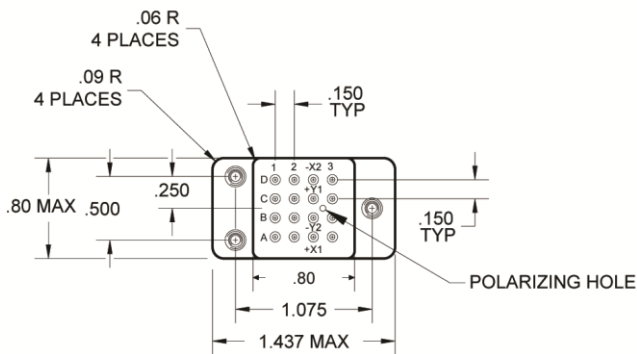

Basic socket series designation for:
Series YL

Designed to the standards and requirements of:
MIL-DTL-12883

SOCKET DRAWING



HARDWARE MOUNTING

MOUNTING DETAIL 3 PLACES

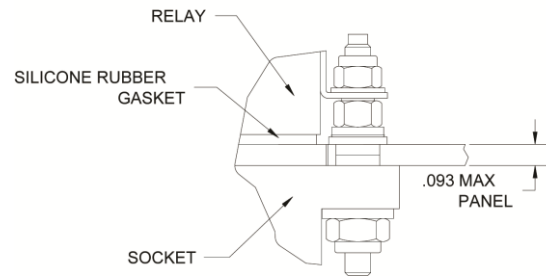

MOUNTING DIMENSIONS

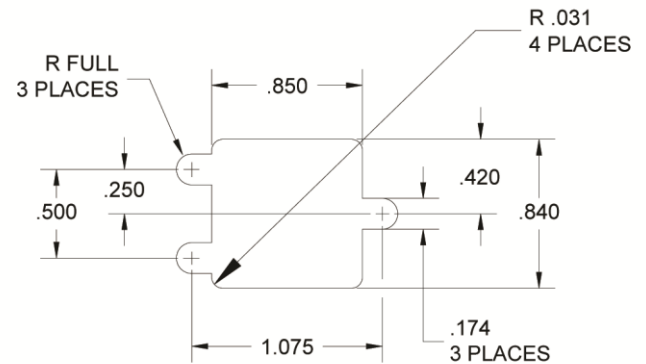
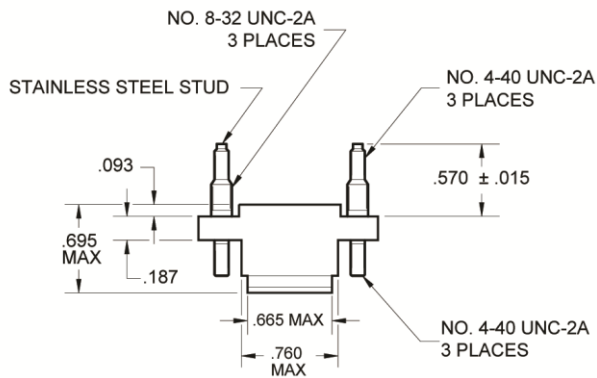

GENERAL CHARACTERISTICS

1. Supplied with mounting hardware and (16) No. 20 contacts and No. 20 crimp.	
2. Standard tolerances	.xx ± .01; xxx ± .005
3. Weight	.052 lbs. max
4. Special track and module available. Please consult factory, See SM-1002-003.	
5. Operating temperature	-65° C to +125° C